

**PERMANENT  
REGULATORY  
OR  
WARNING SIGN**

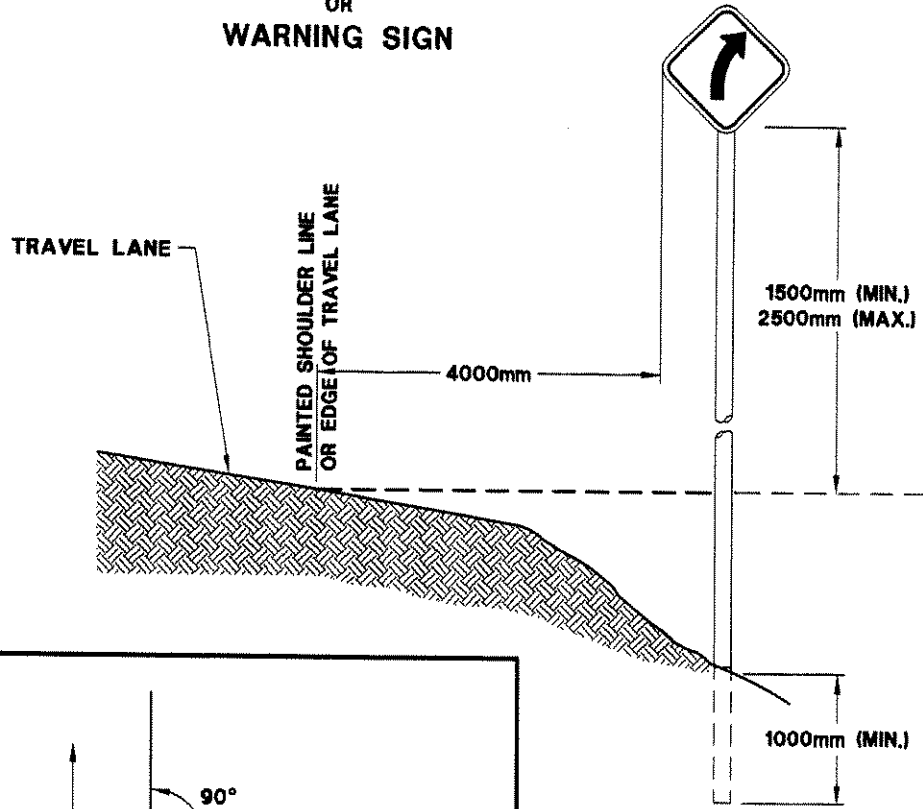

**TEMPORARY  
CONSTRUCTION  
WARNING SIGN**

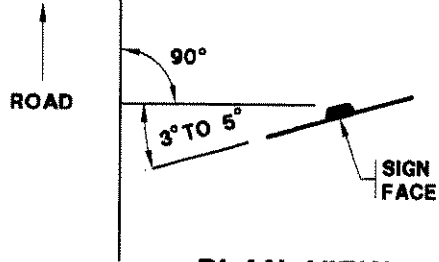
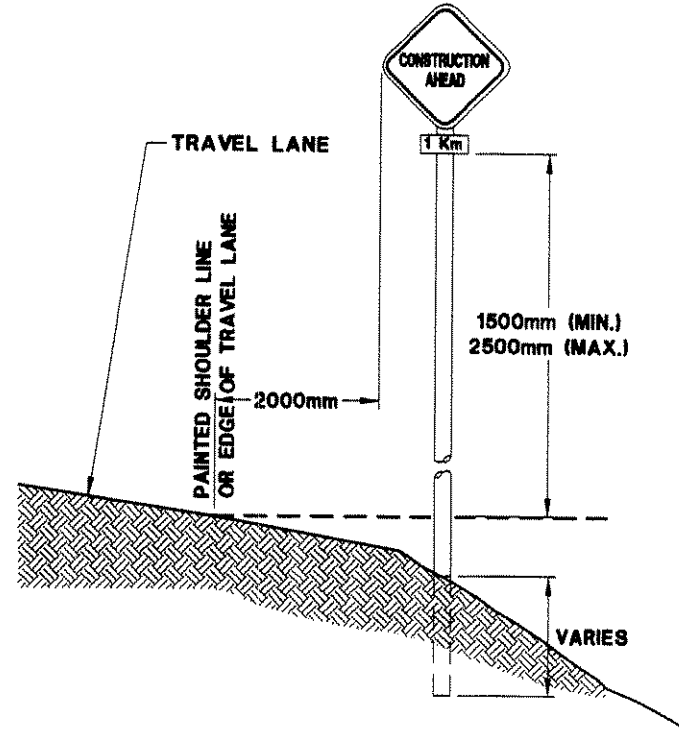

**PLAN VIEW**



SD-200-02-12

**TYPICAL SIGN INSTALLATION HEIGHT  
AND LATERAL LOCATIONS**

Date: DEC. 1995

Revised: APRIL 2005

Approved

Director  
Highways Division

APR 21 2005

Date